

Wet vacuum WSP 2000



This vacuum has endless possibilities

- Vacuum in multi-locations and transport the liquid to a discharge area
- Vacuum large areas and volumes of liquids pumping automatically to a discharge area.



The vacuum cleaner is easy to empty by opening the ball valve and letting the liquid drain out.



Lid for emptying out residual and coarse dirt is unlocked by operating the foot pedal, lid pulled towards rear.



Inside view with installed pump and float switch for suction engine and pump.



The pump is easy to remove, residual dirt emptying lid opened for easy overall cleaning

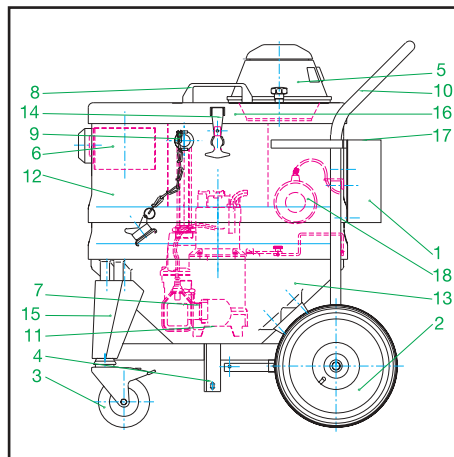

- 1 Switchbox contactor equipment
- 2 Wheel, 300 mm diameter
- 3 Swivel wheel, 125 mm diameter
- 4 Undercarriage and opening unit
- 5 Engine head
- 6 Deflector
- 7 Pump (alternating current 230 V)
- 8 Carrying handle
- 9 GK coupling / Storz coupling
- 10 Pushing handle
- 11 Ballwave, 1"
- 12 GRP interim ring
- 13 Funnel
- 14 Quick-close rubber catch
- 15 Wheel support
- 16 Lid
- 17 On-Off switch
- 18 Float switch

- Pneumatic rear wheels provide stability on rough surfaces.
- The vacuum producer is available in 1,2 - 4 kW
- The vacuum is automatically turned off when a predetermined liquid level is reached within the housing.

Housin	Compression cast composite
L x W x H (mm)	820 x 690 x 940
Inlet (mm)	50 Ø, 2,0"
Pump connection	Industrial cam lock
- bei „Feuerwehrausführung“	Storz-Kupplung
Voltage (Volt)	110/220 single phase, 230/460 three phase
Motorrating (kW)	1,2 - 4
Volume air (ltr./min.)	2.900 - 7.200
Vacuum (mmWC)	2.300
Pump motor (kW)	0,8
Pump volume (m ³ /h) (1 m.)	18
Max. Pump lift (m)	9
Liquid capacity (ltr.)	45 to 100

Technical advice and application assessments, are provided on site, with no obligation !